

LOCATION MAP

MEMORIAL CITY REDEVELOPMENT AUTHORITY

ON BEHALF OF

TAX INCREMENT REINVESTMENT ZONE No.17

APPROXIMATELY 500' OF ROADWAY & SIGNAL IMPROVEMENT
ACROSS FROM MEMORIAL CITY MALL ON KINGSRIDE

WBS No. T-170003-0001-4

Bidding Purposes Only
Not for Construction

NOTE: CITY SIGNATURES VALID FOR ONE YEAR ONLY
AFTER DATE OF SIGNATURES

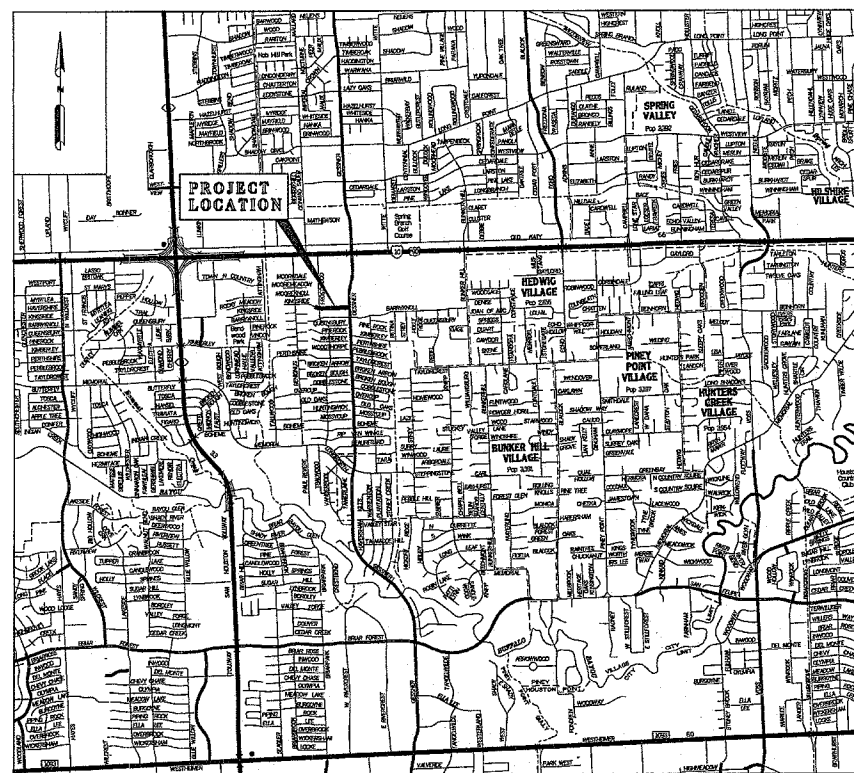

VICINITY MAP

KEY MAP NO 489 D, 490 A
GIMS MAP NO. 4958 D 3
ZIP CODE 77024

THIS PROJECT INCLUDES WORK TO BE PERFORMED IN THE CITY OF
HOUSTON'S RIGHT OF WAY AND MUST BE PERMITTED PRIOR TO
CONSTRUCTION
CONTACT THE REQUIRED SECTIONS BELOW AS INDICATED

LOCATION-3300 MAIN
PAVING 713 535 7579
SANITARY 713 535 7885
✓ WATER 713 535 7885
STORM 713 535 7579

LOCATION-611 WALKER
STREET CUT 713 837 0546

MEMORIAL CITY
REDEVELOPMENT AUTHORITY

OCTOBER, 2007

*NO Proposed Wastewater
Work Involved.

ILMS # 09042529
CON LOG # 2007-0602

LAN PROJECT NO. 120-10308-000-261

LAN Lockwood, Andrews
&Newnam, Inc.
A LEO A DALY COMPANY



Jesus Chavez
10/30/07

CITY OF HOUSTON
DEPARTMENT OF PUBLIC WORKS AND ENGINEERING

[Signature]
11/18/07
WATER

* *M.L. Brown* 11-8-07
WASTEWATER

Zia M. Alshammali
11.5.07
STORMWATER

Robert Kovich 11/18/07
STREET & BRIDGE

CITY ENGINEER DATE

DIRECTOR OF PUBLIC WORKS AND ENGINEERING DATE
SHEET NO 1 OF 50 SHEETS

STORM WATER QUALITY

11-15-07
Naem Alwan
TRAFFIC AND TRANSPORTATION

FACILITIES

CITY DWG NO.

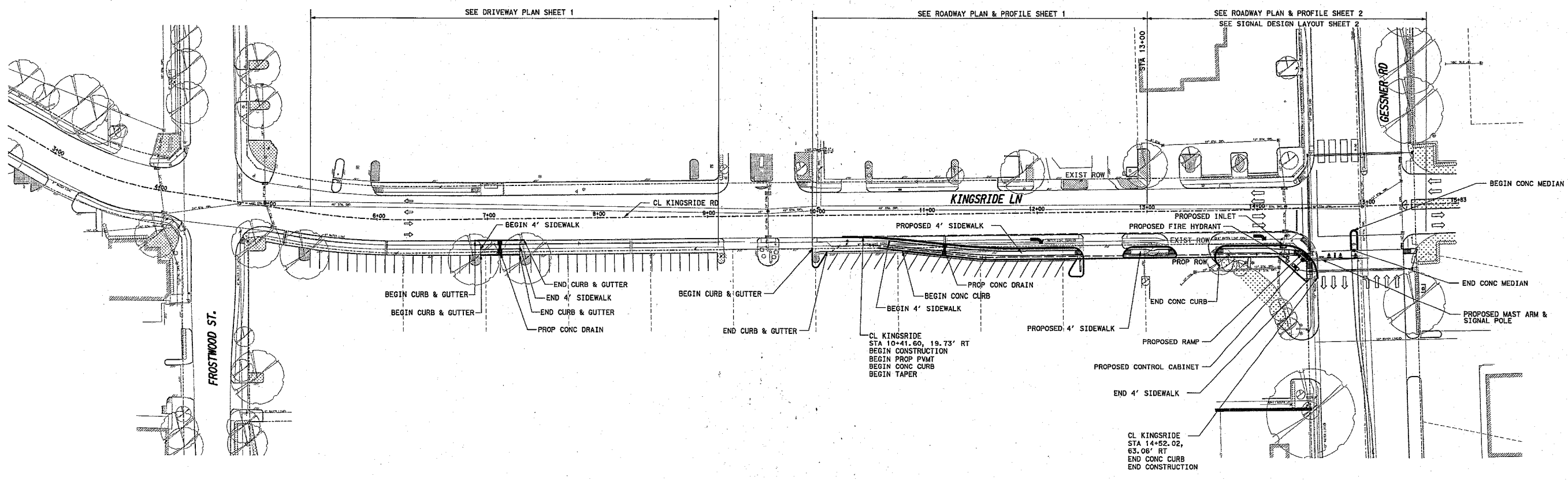
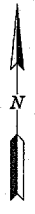

Bidding Purposes Only
Not for Construction

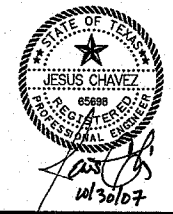

PRIVATE UTILITY LINES SHOWN	
NOTICE: AT LEAST 48 HOURS BEFORE EXCAVATING IN STREET R.O.W. OR EASEMENTS CALL THE LONG STAR NOTIFICATION (713) 223-4567	
<i>Shannon</i>	10/30/07
APPROVED ONLY FOR CROSSING UNDERGROUND FACILITIES, UNLESS OTHERWISE NOTED. DATE VALID AT TIME OF REVIEW AND SIGNATURE VALID FOR ONE YEAR.	
<i>J.C. Muller</i>	10/30/07
APPROVED FOR UNDERGROUND CONDUIT FACILITIES ONLY. DATE SIGNATURE VALID FOR ONE YEAR.	
<i>Shannon</i>	10/30/07
APPROVED FOR TRENCH / GAS FACILITIES (GAS SERVICE LINES ARE NOT SHOWN). DATE	

MEMORIAL CITY REDEVELOPMENT AUTHORITY

Lockwood, Andrews & Newnam, Inc.
A LEO A DALY COMPANY

KINGSRIDE ROADWAY & SIGNAL IMPROVEMENT

PROJECT LAYOUT

SHEET 1 OF 1

CITY OF HOUSTON DEPARTMENT OF PUBLIC WORKS AND ENGINEERING		
WATER <i>J. Williams</i>	WASTEWATER <i>M. S. Crowl 11-8-07</i>	TRAFFIC <i>M. S. Crowl</i>
STORMWATER <i>W. H. ...</i>	STORMWATER <i>J. Williams</i>	STORMWATER <i>J. Williams</i>
FILE NO.:	FACILITY	
DRAWING SCALE:	CITY DWG NO.	
VERT:	CITY DWG NO.	
HORZ: 1" = 50'	CITY DWG NO.	
SHEET:	CITY DWG NO.	
3 OF 50		

USER: K4107481E PLOTTED ON: 10/20/2007

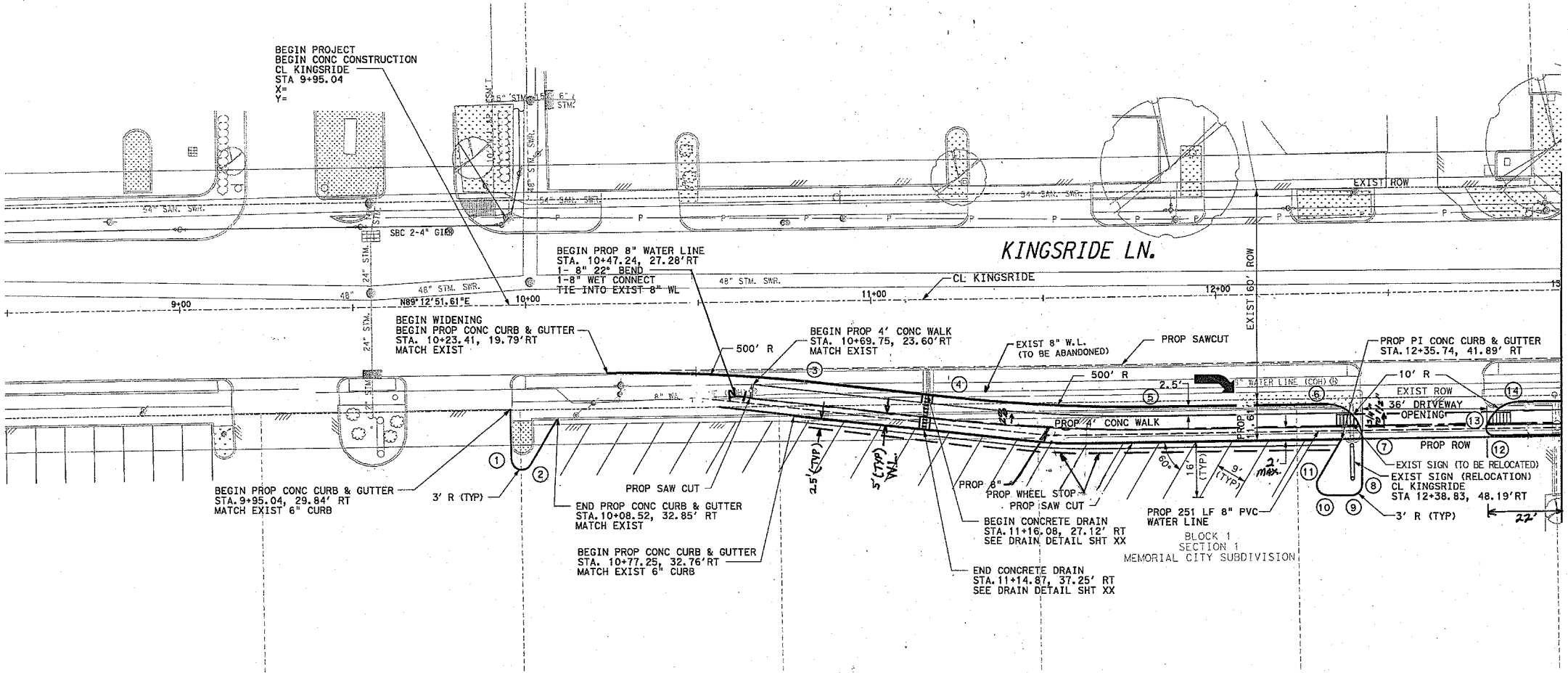

NOTE:
 BEARING ORIENTATION IS BASE ON THE TEXAS STATE PLANE COORDINATE SYSTEM (SOUTH CENTRAL ZONE) NAD83. ESTABLISHED USING STATIC G.P.S. OBSERVATIONS ON APRIL 6, 2004. THE COORDINATES WERE BASED ON CITY OF HOUSTON C.D.R.S. (CONTINUOUSLY OPERATING REFERENCE STATION) NOS. 1 AND 7. COH# 1 X=3,066,266.51 Y=13,807,502.54 (GRID) COH# 7 X=3,078,614.32 Y=13,883,149.46 (GRID) ALL DISTANCES SHOWN ON THE SURVEY ARE SURFACE VALUES AND CAN BE CONVERTED TO GRID BY DIVIDING BY THE COMBINED ADJUSTMENT FACTOR OF 1.0001058949.

LEGEND

- PROP. CONC RAMP
- PROP. FIRE HYDRANT
- PROP. INLET

PROPOSED CURB LOCATION		
1	STA 9+95.15, 44.15' RT	ER
2	STA 10+00.71, 45.69' RT	ER
3	STA 10+84.01, 23.30' RT	ER
4	STA 11+24.53, 28.13' RT	ER
5	STA 11+83.23, 31.64' RT	ER
6	STA 12+31.86, 31.68' RT	ER
7	STA 12+41.84, 41.91' RT	ER
8	STA 12+41.55, 54.96' RT	ER
9	STA 12+38.55, 57.89' RT	ER
10	STA 12+31.34, 57.73' RT	ER
11	STA 12+28.84, 53.17' RT	ER
12	STA 12+79.77, 41.32' RT	ER
13	STA 12+77.86, 38.86' RT	ER
14	STA 12+87.40, 31.74' RT	ER

NOTE:
 ALL TREES SHALL BE PROTECTED AT ALL TIMES DURING CONSTRUCTION AND WILL BE A VIOLATION OF CITY OF HOUSTON STREET TREE ORDINANCE. REFER TO SPECIFICATION 01562 ABD 02915 FOR TREE PROTECTION AND TREE PLANTING SPECIFICATIONS.

Bidding Purposes Only
 Not for Construction

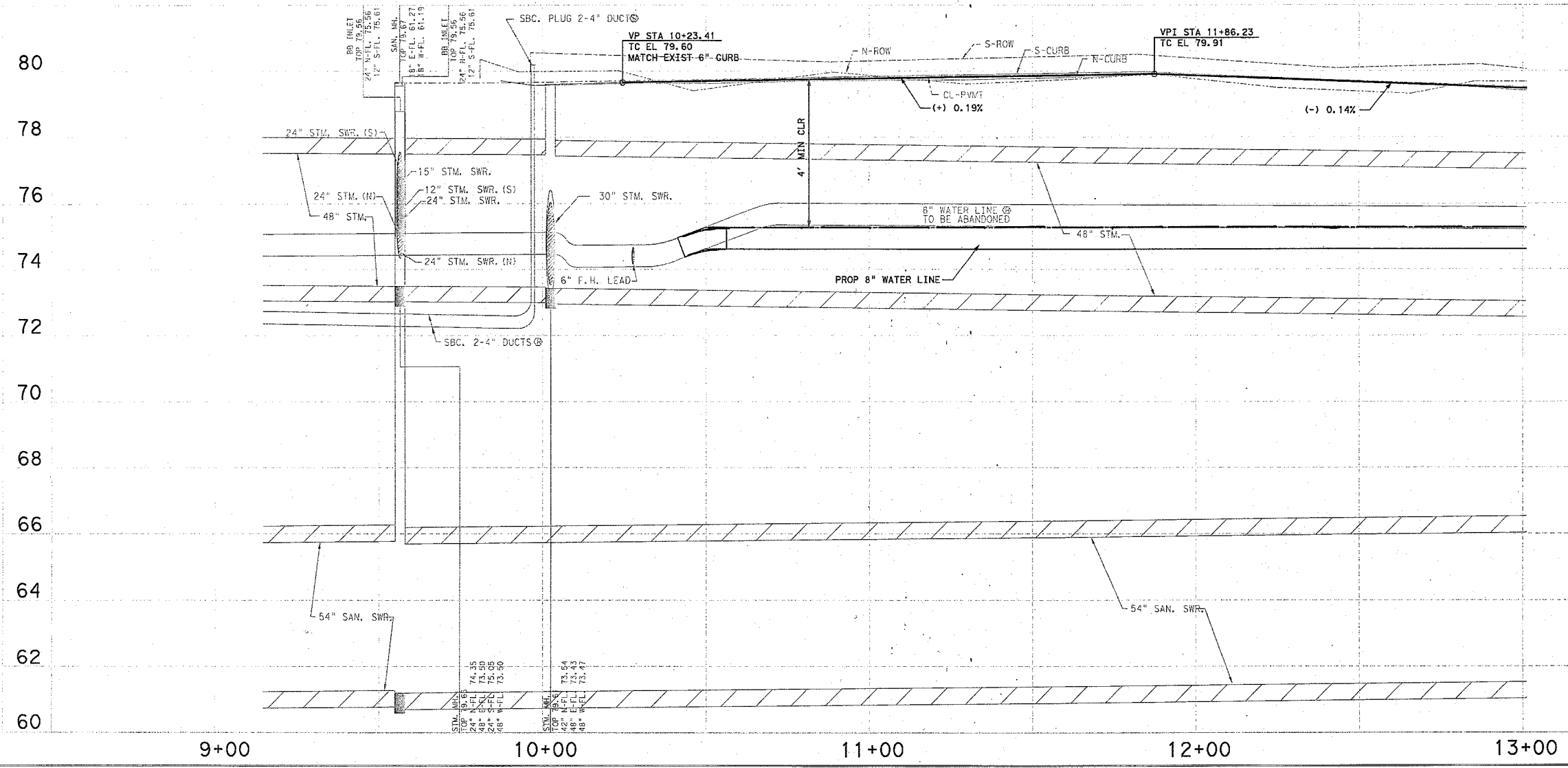
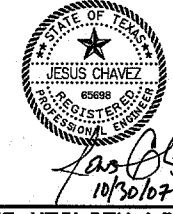

PRIVATE UTILITY LINES SHOWN

NOTICE:
 AT LEAST 48 HOURS BEFORE EXCAVATING IN STREET R.O.W. OR FACEDMENTS CALL THE ONE STOP NOTIFICATION (713)223-4567

<i>[Signature]</i>	10/30/07	DATE
<i>[Signature]</i>	10/30/07	DATE
<i>[Signature]</i>	10/30/07	DATE

MEMORIAL CITY REDEVELOPMENT AUTHORITY

Lockwood, Andrews & Newnam, Inc.
 A LEO A DALY COMPANY

KINGSRIDE ROADWAY & SIGNAL IMPROVEMENT

PROPOSED ROADWAY PLAN & PROFILE

SHEET 1 OF 2

CITY OF HOUSTON DEPARTMENT OF PUBLIC WORKS AND ENGINEERING

WATER	MASTWATER	TRAFFIC
<i>[Signature]</i>	<i>[Signature]</i>	<i>[Signature]</i>
STORMWATER	SWG	
<i>[Signature]</i>	<i>[Signature]</i>	

FILE NO.: _____ FACILITY: _____

DRAWING SCALE: CITY DNG NO. _____

VERT: 1" = 2'
 HORZ: 1" = 20'

SHEET: 16 OF 50

USBR: m_jgtrh116
 PLOTTED ON: 10/30/07
 L:\2007\CA 128-102808-0000\0251A_Plan&Profile\102808-0000\0251A_Plan&Profile.dgn

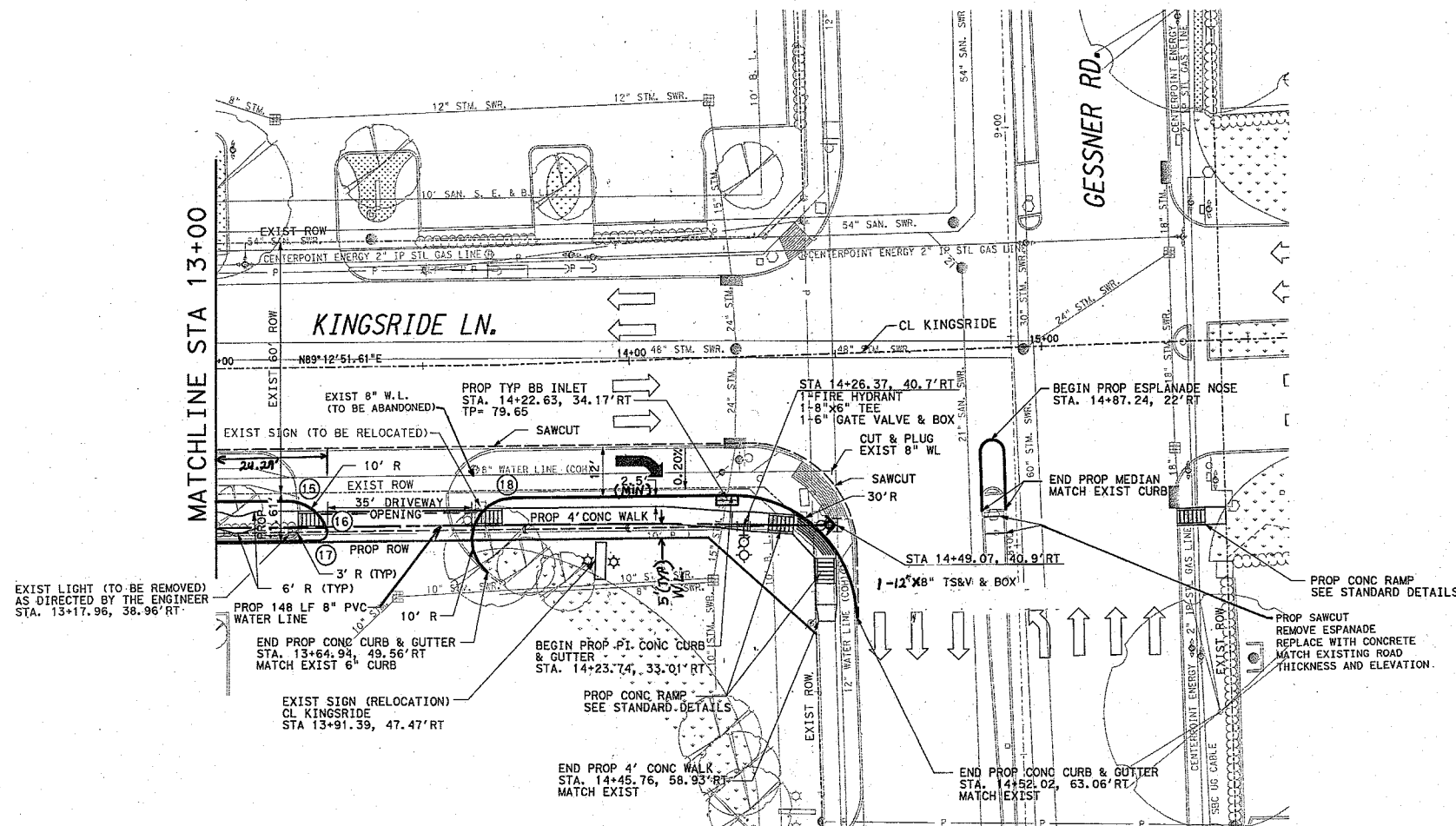

NOTE:
BEARING ORIENTATION IS BASED ON THE TEXAS STATE PLANE COORDINATE SYSTEM (SOUTH CENTRAL ZONE) NAD83. ESTABLISHED USING STATIC G.P.S. OBSERVATIONS ON APRIL 6, 2004. THE COORDINATES WERE BASED ON CITY OF HOUSTON C.D.R.S. (CONTINUOUSLY OPERATING REFERENCE STATION) NOS. 1 AND 7. COH# 1 X=3,066,266.51 Y=13,807,502.54 (GRID) COH# 7 X=3,078,614.32 Y=13,883,149.46 (GRID) ALL DISTANCES SHOWN ON THE SURVEY ARE SURFACE VALUES AND CAN BE CONVERTED TO GRID BY DIVIDING BY THE COMBINED ADJUSTMENT FACTOR OF 1.0001058949.

PROPOSED CURB LOCATION		
(15)	STA 13+16.70, 31.91' RT	ER
(16)	STA 13+26.18, 38.77' RT	ER
(17)	STA 13+24.29, 41.50' RT	ER
(18)	STA 13+71.28, 31.82' RT	ER

LEGEND

- PROP. CONC RAMP
- PROP. FIRE HYDRANT
- PROP. INLET

- NOTE:
- ALL TREES SHALL BE PROTECTED AT ALL TIMES DURING CONSTRUCTION AND WILL BE A VIOLATION OF CITY OF HOUSTON STREET TREE ORDINANCE. REFER TO SPECIFICATION 01662 ADD 02915 FOR TREE PROTECTION AND TREE PLANTING SPECIFICATIONS.
 - FOR ELECTRICAL WIRING AND CONDUIT FOR THE EXISTING SIGN NEW LOCATION, SEE SPECIFICATION FOR INFORMATION.

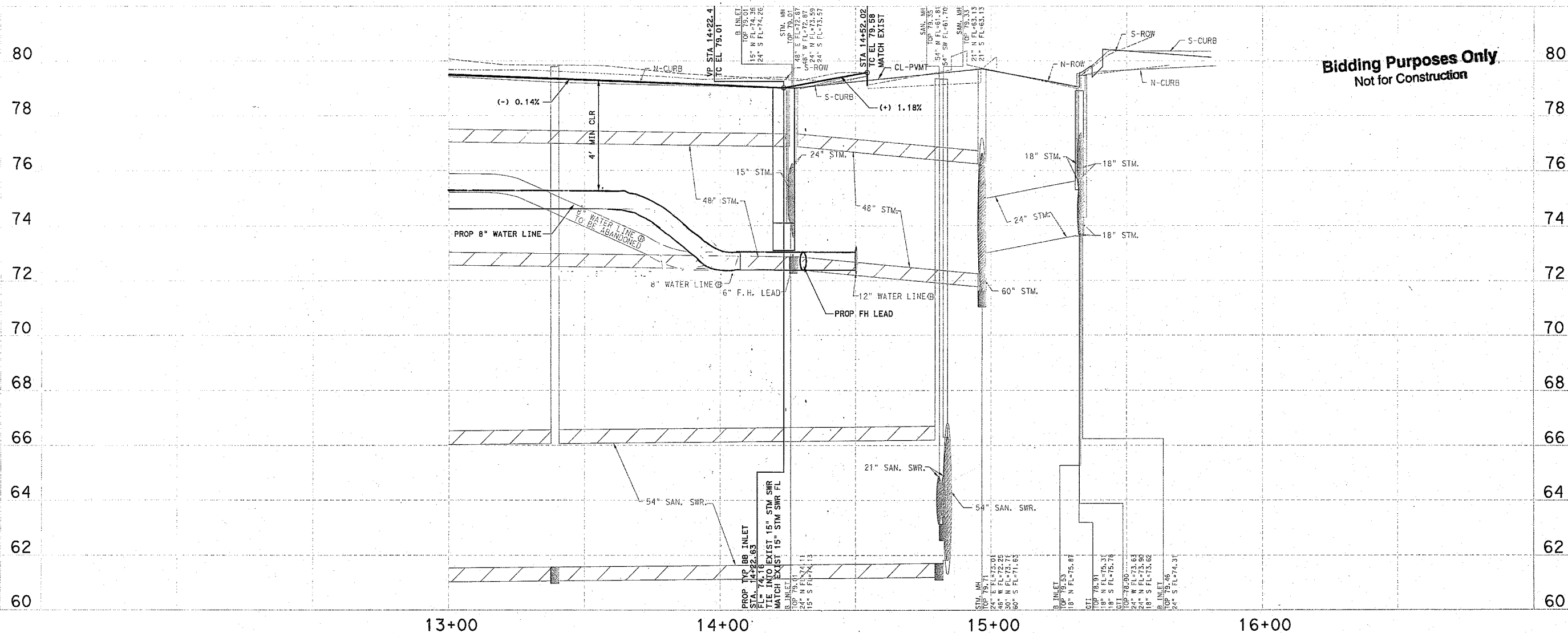
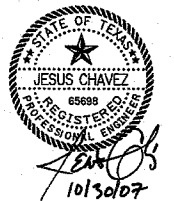

Bidding Purposes Only
Not for Construction

PRIVATE UTILITY LINES SHOWN

NOTICE:
AT LEAST 48 HOURS BEFORE EXCAVATING IN STREET R.O.W. OR EASEMENTS CALL THE ONE STAR NOTIFICATION (713)223-4967

<i>Almon</i>	10/30/07	DATE
<i>J. C. Madley</i>	10/30/07	DATE
<i>Almon</i>	10/30/07	DATE

MEMORIAL CITY REDEVELOPMENT AUTHORITY
Lockwood, Andrews & Newnam, Inc.
A LEO A DALY COMPANY

KINGSRIDE ROADWAY & SIGNAL IMPROVEMENT
PROPOSED ROADWAY PLAN & PROFILE

SHEET 2 OF 2
CITY OF HOUSTON
DEPARTMENT OF PUBLIC WORKS AND ENGINEERING

WATER	WASTEWATER	TRAFFIC
<i>Almon</i>	<i>Almon</i>	<i>Almon</i>
STORMWATER	STORMWATER	STORMWATER
<i>Almon</i>	<i>Almon</i>	<i>Almon</i>

FILE NO.:	FACILITY
DRAWING SCALE:	CITY DNG NO.
VERT: 1" = 2'	
HORZ: 1" = 20'	
SHEET:	17 OF 50

USER: mjgsh414 PLOTTED ON: 10/30/07

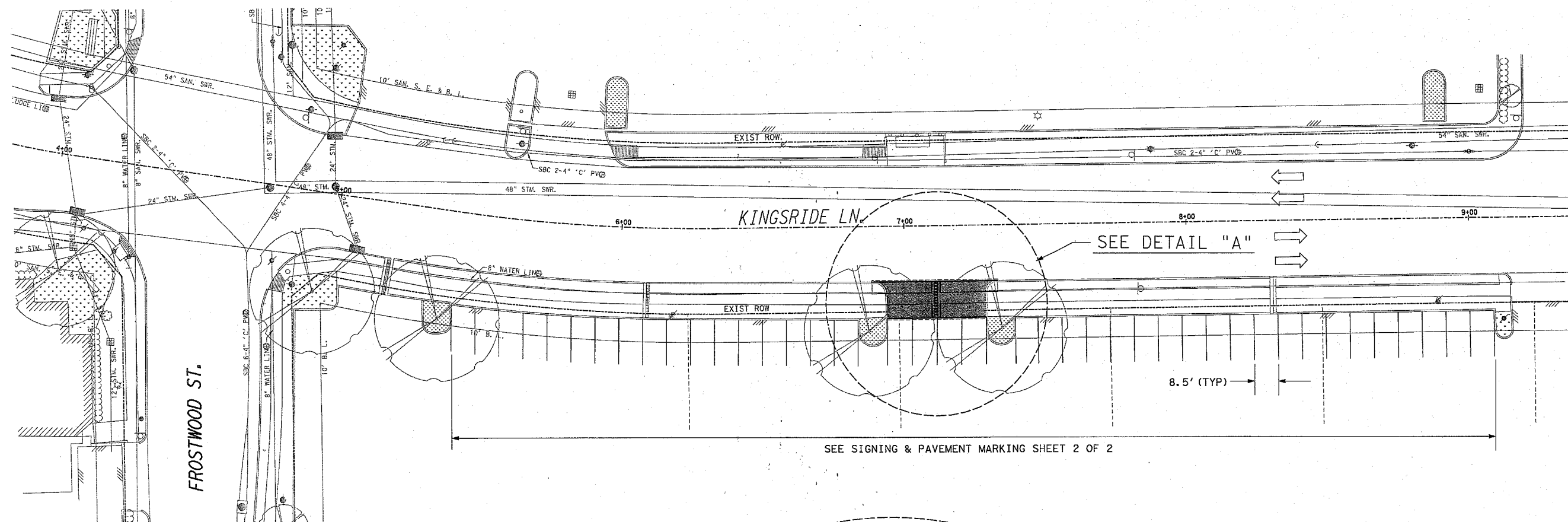

NOTE:
 BEARING ORIENTATION IS BASE ON THE TEXAS STATE PLANE COORDINATE SYSTEM (SOUTH CENTRAL ZONE) NAD83. ESTABLISHED USING STATIC G.P.S. OBSERVATIONS ON APRIL 6, 2004. THE COORDINATES WERE BASED ON CITY OF HOUSTON C.D.R.S. (CONTINUOUSLY OPERATING REFERENCE STATION) NOS. 1 AND 7. COH# 1 X=3,066,266.51 Y=13,807,502.54 (GRID) COH# 7 X=3,078,614.32 Y=13,883,149.46 (GRID) ALL DISTANCES SHOWN ON THE SURVEY ARE SURFACE VALUES AND CAN BE CONVERTED TO GRID BY DIVIDING BY THE COMBINED ADJUSTMENT FACTOR OF 1.0001058949.

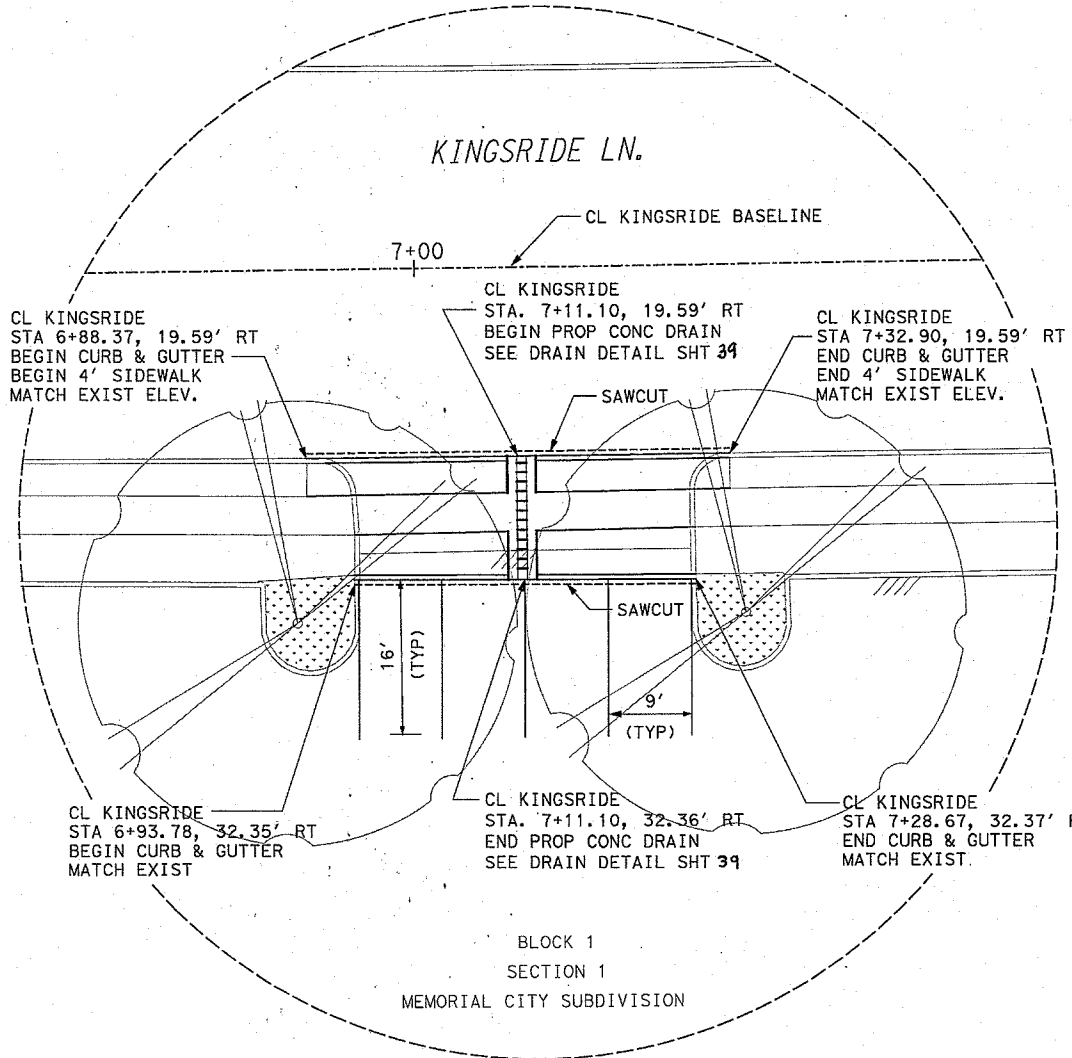
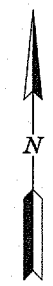

DETAIL "A"

Bidding Purposes Only
 Not for Construction

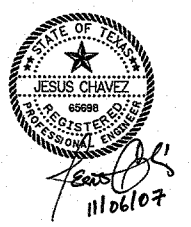

MEMORIAL CITY REDEVELOPMENT AUTHORITY

LAN Lockwood, Andrews & Newnam, Inc.
 A LEO A DALY COMPANY

KINGSRIDE ROADWAY & SIGNAL IMPROVEMENT

PROPOSED DRIVEWAY PLAN

SHEET 1 OF 1

CITY OF HOUSTON
 DEPARTMENT OF PUBLIC WORKS AND ENGINEERING

WATER	MASTER WATER	TRAFFIC
<i>[Signature]</i>	<i>[Signature]</i> 11-8-07	<i>[Signature]</i>
STORM WATER	STORM WATER	SWG
<i>[Signature]</i>	<i>[Signature]</i> 11-8-07	

FILE NO.:

DRAWING SCALE:

VERT: 1" = 20'

HORZ: 1" = 20'

SHEET: 18 OF 50

USER: KADU@TRITE PLOTTED ON: 11/16/2007 CWD FILE: L:\1128214\128-1282B-000A-201\1128214-04-00.dwg

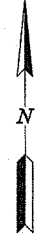

LEGEND

- (A) REMOVE EXIST CONC PVMT
 - (B) REMOVE EXIST CURB
 - (C) REMOVE EXIST 4' CONC WALK
 - (D) REMOVE EXIST INLET (TY A)
 - (E) REMOVE EXIST CONC RAMP
 - (F) REMOVE EXIST CONC DRIVE
 - (G) REMOVE EXIST ASPHALT
 - (H) REMOVE EXIST FIRE HYDRANT AND SALVAGE FH
 - (I) REMOVE EXIST PAV MARKING
 - (J) RELOCATE SPRINKLER VALVES
 - (K) REMOVE EXIST 8" WATER LINE
- CONC PVMT TO BE REMOVED
 - ASPHALT PVMT TO BE REMOVED
 - CONC SIDEWALK TO BE REMOVED

Bidding Purposes Only
Not for Construction

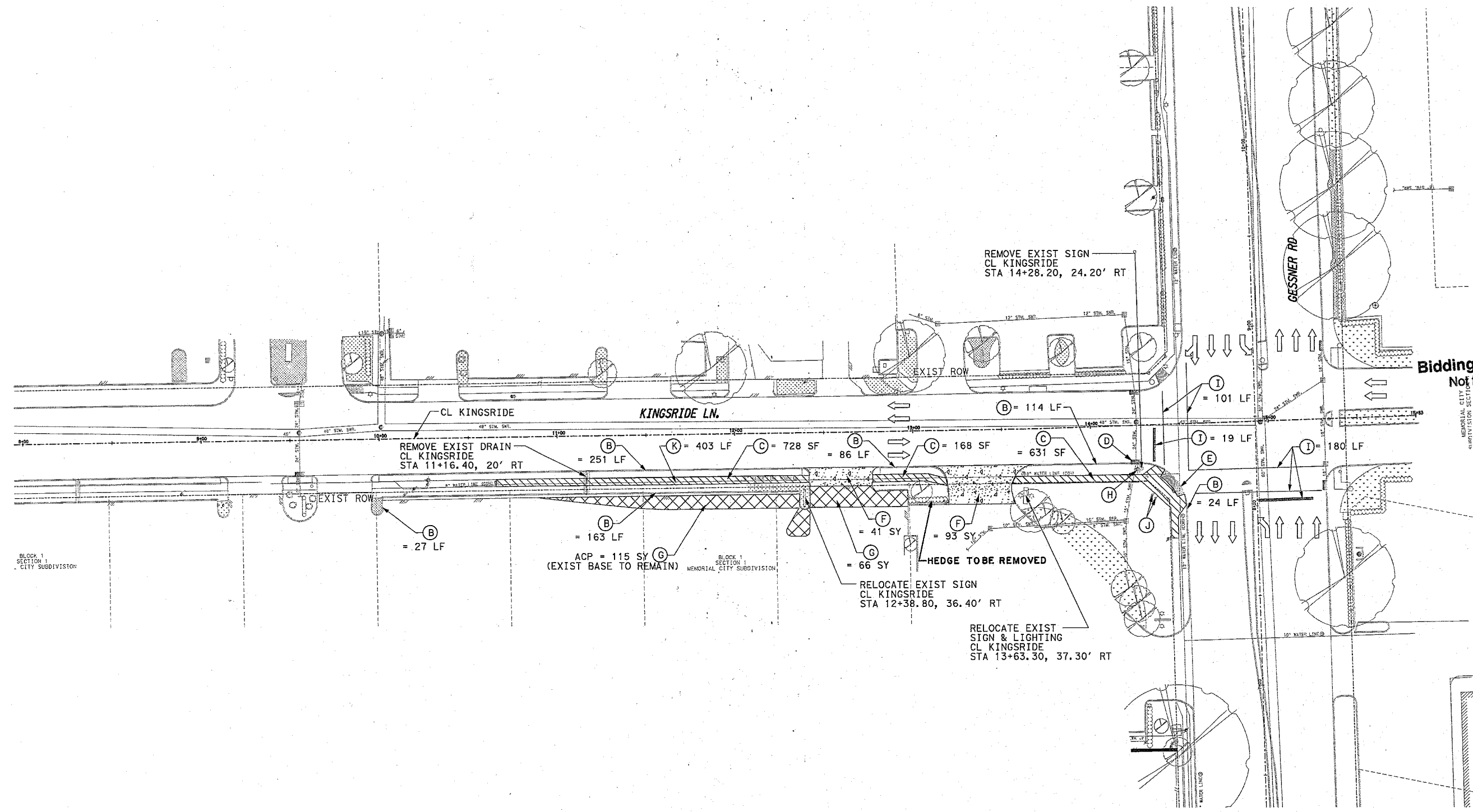

BLOCK 1
SECTION 1
CITY SUBDIVISION

BLOCK 1
SECTION 1
MEMORIAL CITY SUBDIVISION

- NOTE:**
- FOR ADDITIONAL INFORMATION ON RELOCATED SIGNS SEE "SIGNING & PAVEMENT MARKING LAYOUT" SHEETS.
 - ALL TREE SHALL BE PROTECTED AT ALL TIME DURING CONSTRUCTION AND WILL BE A VIOLATION OF CITY OF HOUSTON STREET TREE ORDINANCE. REFER SPECIFICATION 01562 ABD 02915 FOR TREE PROTECTION AND TREE PLANTING SPECIFICATIONS.

PRIVATE UTILITY LINES SHOWN		
<small>NOTICE:</small> AT LEAST 48 HOURS BEFORE EXCAVATING IN STREET R.O.W. OR EASEMENTS CALL THE LONE STAR NOTIFICATION (713)223-4567		
<small>CONFIRMED ENERGY / ELECTRIC FACILITIES</small> <small>(APPROVED ONLY FOR CROSSING UNDERGROUND OUTLINES, UNLESS OTHERWISE NOTED.)</small> <small>VALID AT TIME OF REVIEW ONLY.</small>	DATE	
N/A		
<small>SDG (APPROVED FOR UNDERGROUND CONDUIT FACILITIES ONLY.)</small> <small>SIGNATURE VALID FOR ONE YEAR</small>	DATE	
N/A		
<small>CONFIRMED ENERGY / GAS FACILITIES</small> <small>(GAS SERVICE LINES ARE NOT SHOWN.)</small>	DATE	
N/A		
MEMORIAL CITY REDEVELOPMENT AUTHORITY		
Lockwood, Andrews & Newnam, Inc. A LEO A DALY COMPANY		
KINGSRIDE ROADWAY & SIGNAL IMPROVEMENT		
DEMOLITION PLAN		
SHEET 1 OF 2		
CITY OF HOUSTON DEPARTMENT OF PUBLIC WORKS AND ENGINEERING		
<small>WATER</small> 	<small>WASTEWATER</small> 	<small>TRAFFIC</small>
<small>STORMWATER</small> 	<small>SDG</small> 	
FILE NO.:	FACILITY	
DRAWING SCALE:	CITY DWG NO.	
VERT:		
HORZ:	1" = 30'	
SHEET:	19 OF 50	

USER: m_jgubt-vr-1e
 PLOTTED ON: 10/20/2007
 CAD FILE: L:\12821\128-182906-000-000-251\Prod\AS+B\Draw\Sign\Demolition\KINGSRIDE.DWG, 10289-000-1.dgn

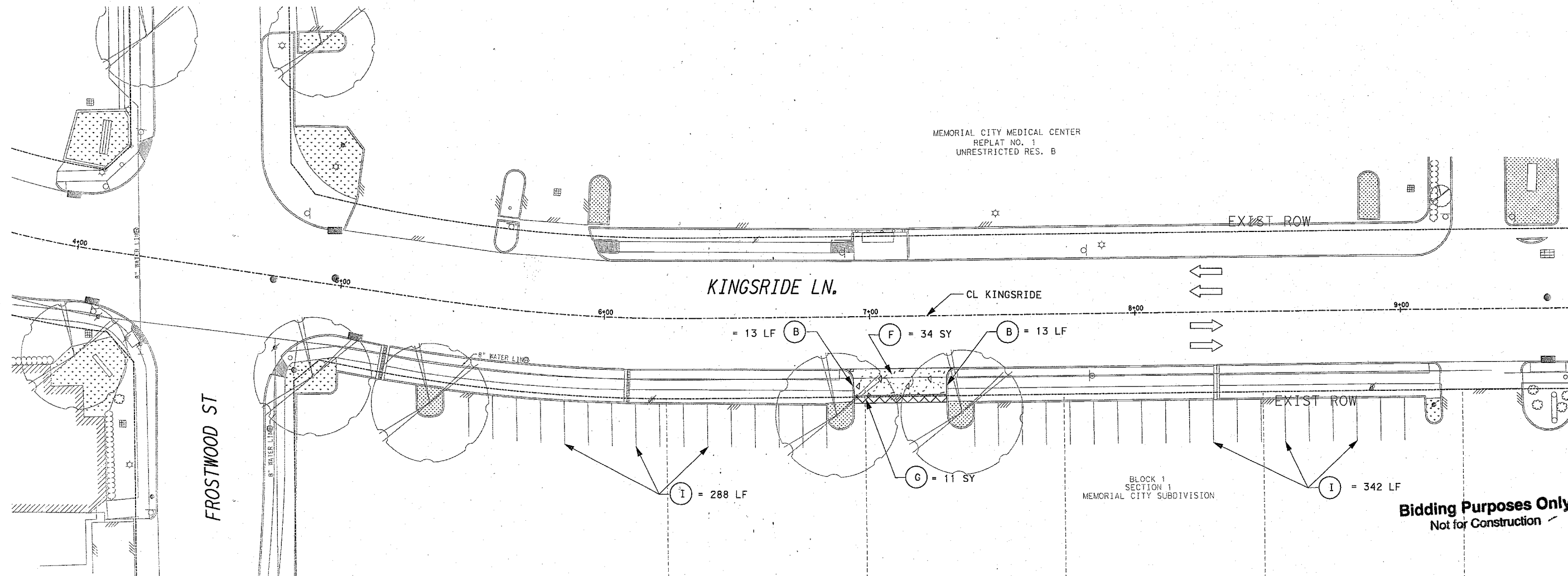

MEMORIAL CITY MEDICAL CENTER
REPLAT NO. 1
UNRESTRICTED RES. B

KINGSRIDE LN.

FROSTWOOD ST

BLOCK 1
SECTION 1
MEMORIAL CITY SUBDIVISION

Bidding Purposes Only
Not for Construction

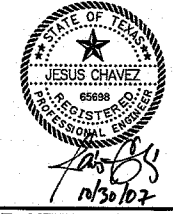

LEGEND

- (A) REMOVE EXIST CONC PVMT
- (B) REMOVE EXIST CURB
- (C) REMOVE EXIST 4' CONC WALK
- (D) REMOVE EXIST INLET (TY A)
- (E) REMOVE EXIST CONC RAMP
- (F) REMOVE EXIST CONC DRIVE
- (G) REMOVE EXIST ASPHALT
- (H) REMOVE EXIST FIRE HYDRANT
- (I) REMOVE EXIST PAV MARKING
- (J) RELOCATE SPRINKLER VALVES

- CONC PVMT TO BE REMOVED
- ASPHALT PVMT TO BE REMOVED
- CONC SIDEWALK TO BE REMOVED

NOTE:
1. FOR ADDITIONAL INFORMATION ON RELOCATED SIGNS SEE "SIGNING & PAVEMENT MARKING LAYOUT" SHEETS.
2. ALL TREES SHALL BE PROTECTED AT ALL TIMES DURING CONSTRUCTION AND WILL BE A VIOLATION OF CITY OF HOUSTON STREET TREE ORDINANCE. REFER TO SPECIFICATION 01562 ABD 02915 FOR TREE PROTECTION AND TREE PLANTING SPECIFICATIONS.

PRIVATE UTILITY LINES SHOWN														
NOTICE: AT LEAST 48 HOURS BEFORE EXCAVATING IN STREET R.O.W. OR EASEMENTS CALL THE LONG STAR NOTIFICATION (713)223-4567														
N/A	DATE													
SUBMITTANT ENERGY / ELECTRIC FACILITIES (APPROVED ONLY FOR CROSSING UNDERGROUND FACILITIES, UNLESS OTHERWISE NOTED.) VALID AT TIME OF REVIEW ONLY.														
N/A	DATE													
SDG (APPROVED FOR UNDERGROUND CONDUIT FACILITIES ONLY.) SIGNATURE VALID FOR ONE YEAR														
N/A	DATE													
SUBMITTANT ENERGY / GAS FACILITIES (GAS SERVICE LINES ARE NOT SHOWN.)														
<p align="center">MEMORIAL CITY REDEVELOPMENT AUTHORITY</p> <p>LAN Lockwood, Andrews & Newnam, Inc. A LEO A DALY COMPANY</p> <p align="center">KINGSRIDE ROADWAY & SIGNAL IMPROVEMENT</p> <p align="center">DEMOLITION PLAN</p> <p align="right">SHEET 2 OF 2</p> <p align="center">CITY OF HOUSTON DEPARTMENT OF PUBLIC WORKS AND ENGINEERING</p> <table border="1"> <tr> <td>WATER</td> <td>WASTEWATER</td> <td>TRAFFIC</td> </tr> <tr> <td><i>[Signature]</i></td> <td><i>[Signature]</i></td> <td><i>[Signature]</i></td> </tr> <tr> <td>STORMWATER</td> <td>SWG</td> <td></td> </tr> <tr> <td><i>[Signature]</i></td> <td><i>[Signature]</i></td> <td></td> </tr> </table>			WATER	WASTEWATER	TRAFFIC	<i>[Signature]</i>	<i>[Signature]</i>	<i>[Signature]</i>	STORMWATER	SWG		<i>[Signature]</i>	<i>[Signature]</i>	
WATER	WASTEWATER	TRAFFIC												
<i>[Signature]</i>	<i>[Signature]</i>	<i>[Signature]</i>												
STORMWATER	SWG													
<i>[Signature]</i>	<i>[Signature]</i>													
FILE NO.:	FACILITY													
DRAWING SCALE:	CITY DWG NO.													
VERT:														
HORZ:	1" = 20'													
SHEET:	20 OF 50													

USDR: m_jg:sh:14
 PLOTTED ON: 10/30/2007
 CAD FILE: L:\12824\128-18238R-2006\281\Prod\5-04-06\1gm-Ref\eremon\FONDA\N\12838B-DEMO-2.dwg

SIGNS

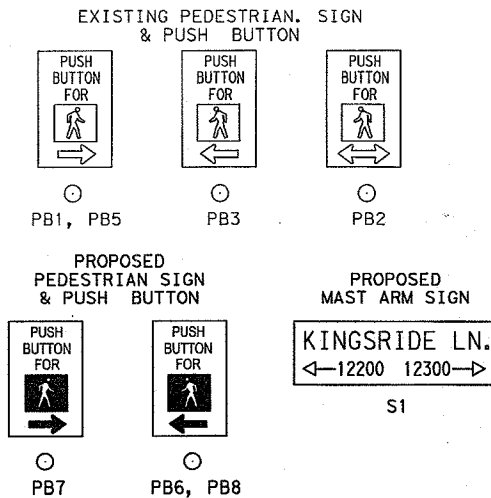

SIGNALS

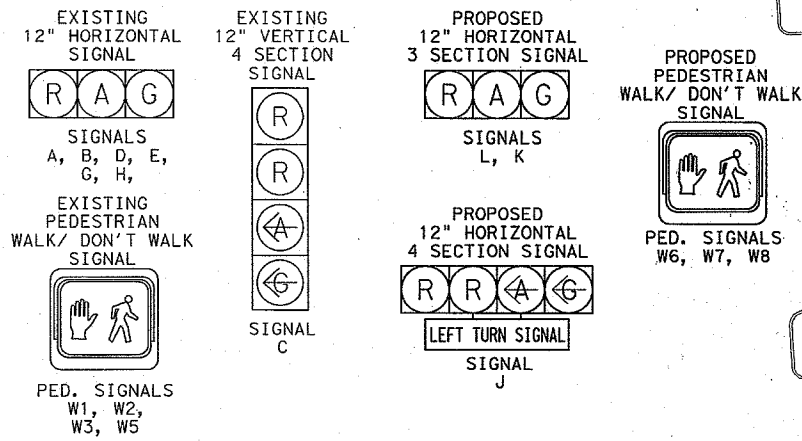

NOTES

1. DETECTION ZONE LOCATIONS TO BE DETERMINED BY ENGINEER IN THE FIELD.
2. THE LOCATION OF UNDERGROUND UTILITIES IS APPROXIMATE.
3. CALL THE TEXAS ONE CALL LOCATOR AT 1-800-344-8377, 48 HOURS BEFORE BEGINNING CONSTRUCTION.
4. SEE CITY OF HOUSTON PEDESTRIAN CURB RAMP STANDARD SHEETS FOR ADDITIONAL DETAIL.

LEGEND

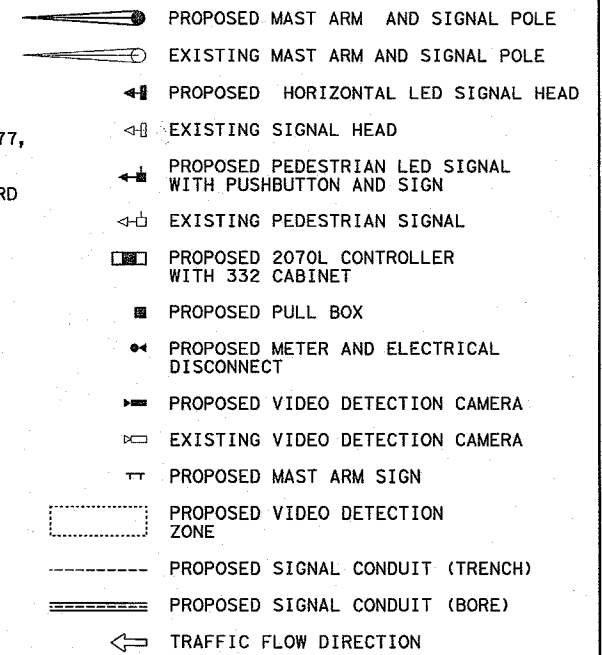

TRAFFIC EQUIPMENT SCHEDULE

POLE LOCATION	EXISTING 1	EXISTING 2	EXISTING 3	EXISTING 4	PROPOSED 5	6	CONTROLLER
FOUNDATION/DEPTH	24-A	24-A	30-A	30-A'	STA 14+39.47 47.20' RT	STA 14+42.81 111.58' RT	STA 14+32.66 53.57' RT
ATTACHMENTS	24' MA W1, W8 PB1, PB8	24' POLE W10, PB9	32' MA W3, PB3	24' MA W5, PB5	60' MA W6, W7 PB6, PB7	METER & DISCONNECT	MODEL 332 CABINET/ MODEL 2070 CONTROLLER

VIVDS CAMERA CHART

CAMERA	DETECTION ZONE
V1	NB APPROACH (EXISTING)
V2	EB APPROACH (EXISTING)
V3	SB APPROACH (PROPOSED)
V4	WB APPROACH (EXISTING)

ELECTRICAL SCHEDULE

ITEM	ITEM	1	2	3	4	5	6	7	8	9	10	11	12	13	14	15	16	17	18	19	20	21	22	23
POWER	#6 XHHW		3	3																				
GROUND	#8 BARE COPPER	1	1	1	1	1	1	1	1	1	1	1	1	1	1	1	1	1	1	1	1	1	1	
PED. PUSH BUTTON	2/C #14		7	4	2	2		1	1	1	1	1	1	1	1	1	1	1	1	1	2			
PED. SIGNAL	4/C #14		8	5	2	3		2	1	1	1	1	1	1	1	1	1	1	1	1	2			
VEHICLE SIGNAL	7/C #14		7	5	2	3		1	2	2	2	2	2	2	2	2	2	2	2	2	3	2	1	3
LUMINAIRE	3/C #12 TRAY CABLE																							
VIVDS CABLE	RG-59 COAX			3		2		1		1		1		1		1		1		1		1		
VIVDS POWER	3C-#16			3		2		1		1		1		1		1		1		1		1		
CONDUIT	2" PVC (SCHD. 80)			1		1		1		1		1		1		1		1		1		1		
	2" PVC (SCHD. 80) (BORE)					1		1		1		1		1		1		1		1		1		
	3" PVC (SCHD. 80)					1		1		1		1		1		1		1		1		1		
	3" PVC (SCHD. 80) (BORE)					1		1		1		1		1		1		1		1		1		
	2" RIGID METAL					1		1		1		1		1		1		1		1		1		
4" RIGID METAL					1		1		1		1		1		1		1		1		1		1	
5" PVC (SCHD. 80)					1		1		1		1		1		1		1		1		1		1	

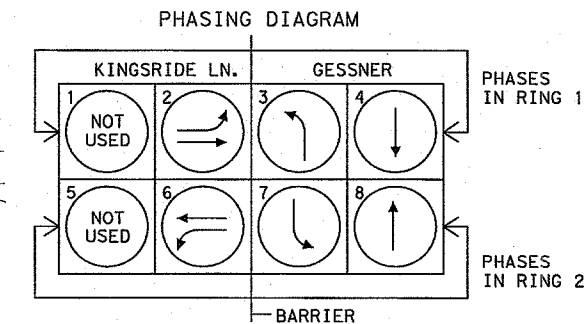

BENCH MARK INFORMATION:
 BEARING ORIENTATION IS BASE ON THE TEXAS STATE PLANE COORDINATE SYSTEM (SOUTH CENTRAL ZONE) NAD83. ESTABLISHED USING STATIC G.P.S. OBSERVATIONS ON APRIL 6, 2004. THE COORDINATES WERE BASED ON CITY OF HOUSTON C.D.R.S. (CONTINUOUSLY OPERATING REFERENCE STATION) NOS. 1 AND 7.
 COH# 1 X=3,066,266.51 Y=13,807,502.54 (GRID)
 COH# 7 X=3,078,614.32 Y=13,883,149.46 (GRID)
 ALL DISTANCES SHOWN ON THE SURVEY ARE SURFACE VALUES AND CAN BE CONVERTED TO GRID BY DIVIDING BY THE COMBINED ADJUSTMENT FACTOR OF 1.0001058949.

Bidding Purposes Only
 Not for Construction

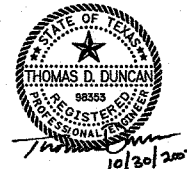

PRIVATE UTILITY LINES SHOWN

NOTICE: AT LEAST 48 HOURS BEFORE EXCAVATING IN STREET R.O.W. OR EASEMENTS CALL THE ONE CALL NOTIFICATION (713)223-4567

APPROVED FOR CROSSING UNDERGROUND FACILITIES (APPROVED ONLY FOR CROSSING UNDERGROUND FACILITIES, UNLESS OTHERWISE NOTED.)	DATE
<i>J.P. Miller</i>	10/30/07
APPROVED FOR UNDERGROUND CONDUIT FACILITIES ONLY. (FORMING VALID FOR ONE YEAR)	DATE
<i>J.P. Miller</i>	10/30/07

MEMORIAL CITY REDEVELOPMENT AUTHORITY

Lockwood, Andrews & Newnam, Inc.
 A LEO A DALY COMPANY

KINGSRIDE ROADWAY & SIGNAL IMPROVEMENT

SIGNAL DESIGN LAYOUT KINGSRIDE LANE AT GESSNER ROAD

CITY OF HOUSTON
 DEPARTMENT OF PUBLIC WORKS AND ENGINEERING

WATER	STORMWATER	TRAFFIC
<i>Handwritten</i>	<i>Handwritten</i>	<i>Handwritten</i>
FILE NO.:	FACILITY	
DRAWING SCALE:	CITY DWG NO.	
VERT. SCALE: 1"=20'		
HORIZ.:		
SHEET:	31 OF 50	