

I - 10

MATCHLINE SEE "A" THIS SHEET

MATCHLINE SEE "A" THIS SHEET

MATCHLINE SEE SHEET L1.02





LANDSCAPE ARCHITECTURE
 SITE PLANNING
 URBAN DESIGN

7155 OLD KATY ROAD
 SUITE 270
 HOUSTON, TEXAS 77024
 713-869-8987
 713-869-0908 FAX
 WWW.KWTEXAS.COM

PROJECT NUMBER
 MCD-705

SCALE 1" = 20' - 0"

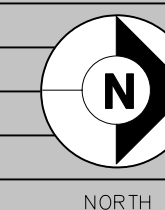

SHEET TITLE
 PLANTING PLAN

SHEET NUMBER
 L3.01

PLANT KEY		
ABV	BOTANICAL NAME/ COMMON NAME	
TREES		
LO	QUERCUS VIRGINIANA LIVE OAK	100 Gal.
LO1	QUERCUS VIRGINIANA LIVE OAK	30 Gal.
NO	QUERCUS NUTTALLII NUTTALL OAK	
WO	QUERCUS NIGRA WATER OAK	
LP	PINUS TAEDA LOBLOLLY PINE	
LPI	PINUS TAEDA LOBLOLLY PINE	
CM	LAGERSTROEMIA INDICA GRAPE MYRTLE	
WM	MYRICA CERIFERA WAX MYRTLE	
WMI	MYRICA CERIFERA WAX MYRTLE	
YP	ILEX VOITATORA YAUPON HOLLY	
PALMS		
MP	PHOENIX DACTYLIFERA MEDJOL MEDJOL PALM	
SHRUBS		
DOP	NERIUM OLEANDER PETITE PINK DWARF PINK OLEANDER	
BW	SPIRAEA PRUNIFOLIA BRIDAL WREATH SPIREA	
UR	ROSMARINUS OFFICINALIS UPRIGHT ROSEMARY	
VP	LIGUSTRUM SINENSE VAREGATUM VAREGATED PRIVET	
CL	ERIOBOTRYA X COPPERTONE COPPERTONE LOGLIAT	
NWR	ROSA SP NEARLY WILD ROSE	
GRASS		
HM	PENNISETUM ALOPECUROIDES HAMELN HAMELN GRASS	
GROUNDCOVERS		
LI	LIRIOPE MUSCARI LIRIOPE	
BF	DIETES VEGETA BUTTERFLY IRIS	
AJ	TRACHELOSPERMUM ASIATICUM ASIAN JASMINE	
TURF		
	CYNODON DACTYLON COMMON BERMUDA	

- ### GENERAL NOTES
- 1) Planting soil mixture shall be composed the following:
 40% Topsoil
 30% Shredded Bark Mulch
 30% Sand
 - 2) Bidding contractors be advised that all new tree material is to be container-grown corresponding to stated root ball sizes as recognized by industry standards. This shall include all B&B, machine moved, or trans-planted trees from the bidding process unless otherwise indicated on the plan. The installation contractor shall be prepared to provide photographs of intended plant material along with signed clarification that plant material meets these requirements and that no variations or substitutions have been made.
 - 3) The Landscape Contractor doing the installation of this work shall submit to Kudela & Weinheimer information regarding sourcing of plant material.
 All plant material must be container-grown and approved at the source of growth by Kudela & Weinheimer. Tree material meeting the specifications will be tagged with a serialized tagging tag at the nursery by Kudela & Weinheimer. Plants arriving at the job site without these tags will be categorically rejected at contractor's expense.
 - 4) If the planting plan does not agree with the plant list the quantities indicated graphically on the planting plan shall govern.
 - 5) Contractor is responsible for the grading of parking lot islands and setbacks. Grade changes shall range from 8" to 15" above the curb depending on the size of the island. Select topsoil shall be used for these berms. See Parking Island Tree Detail.
 - 6) All unsurfaced areas are to receive four inches of topsoil, seed, mulch or sod, and watered until a healthy stand of grass is established.

LEGEND

	EXISTING TREE
	NURSERY GROWN CONTAINERIZED TREES
	MEDJOL PALM
	LOBLOLLY PINE
	MULTI-TRUNK TREES
	SHRUBS/GROUNDCOVER
	SOLID SOD - BERMUDA

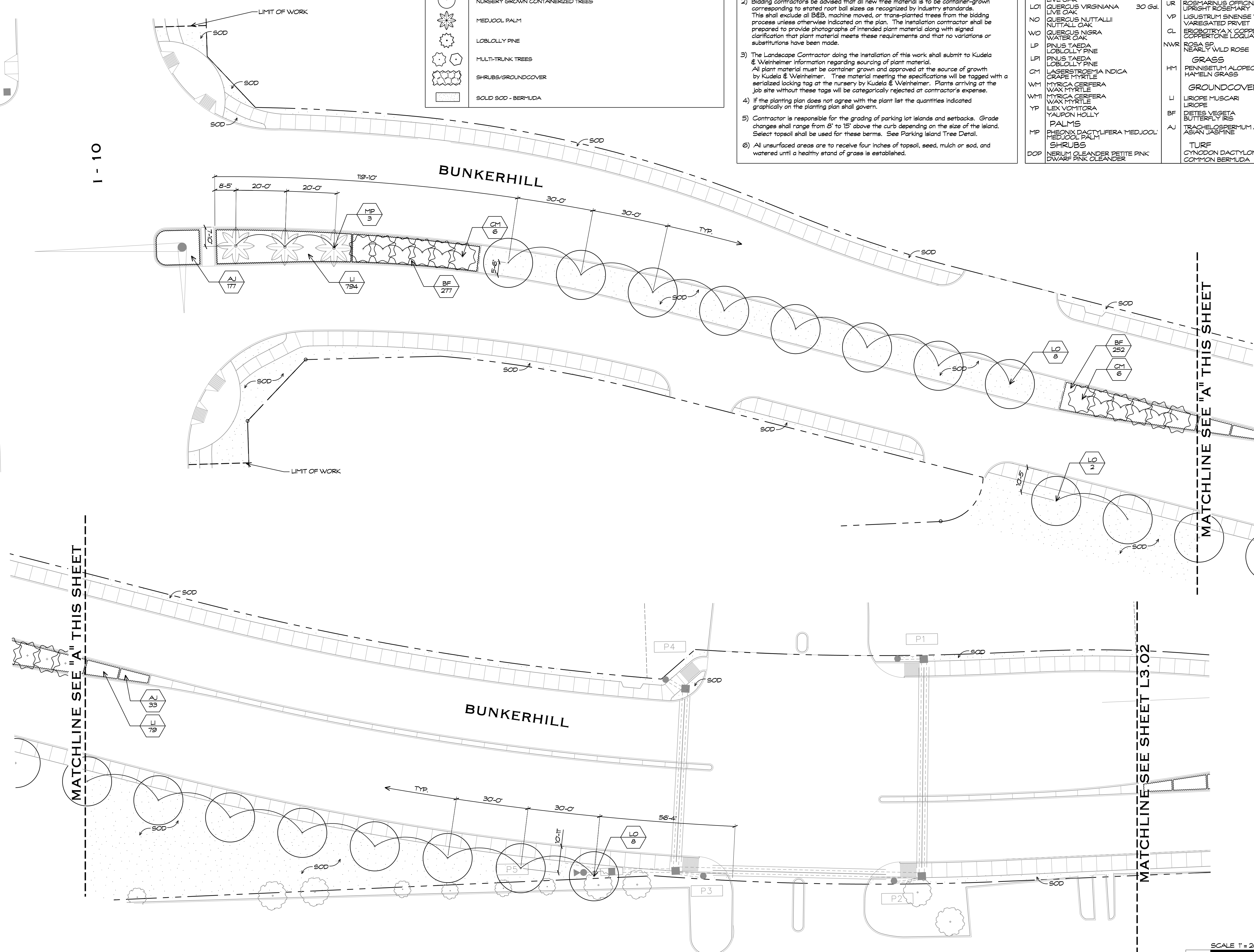

PLANT KEY

ABV	BOTANICAL NAME/ COMMON NAME		
TREES			
LO	QUERCUS VIRGINIANA LIVE OAK	100 Gal.	BW
LO1	QUERCUS VIRGINIANA LIVE OAK	30 Gal.	UR
NO	QUERCUS NUTTALLI NUTTALL OAK		VP
WO	QUERCUS NIGRA WATER OAK		CL
LP	PNUS TAEDA LOBLOLLY PINE		NWR
LPI	PNUS TAEDA LOBLOLLY PINE		
CI	LAGERSTROEMIA INDICA GRAPE MYRTLE		HM
WM	MYRICA CERIFERA WAX MYRTLE		
WM1	MYRICA CERIFERA WAX MYRTLE		
YP	ILEX VOMITORIA YALPON HOLLY		BF
MP	PHENIX DACTYLIFERA MEDJOO' PALM		AJ
DOP	NERIUM OLEANDER DWARF PINK OLEANDER		
GRASS			
	PENNISETUM ALOPECUROIDES HAMELN GRASS		HM
GROUNDCOVERS			
	LIRIOPE MUSCARI LIRIOPE		LI
	DIETES VEGETA BUTTERFLY IRIS		BF
	TRACHELOSPERMUM ASIATICUM ASIAN JASMINE		AJ
TURF			
	CYNODON DACTYLON COMMON BERMUDA		

GENERAL NOTES

- Planting soil mixture shall be composed the following:
40% Topsoil
30% Shredded Bark Mulch
30% Sand
- Bidding contractors be advised that all new tree material is to be container-grown corresponding to stated root ball sizes as recognized by industry standards. This shall exclude all B&B, machine moved, or trans-planted trees from the bidding process unless otherwise indicated on this plan. The installation contractor shall be prepared to provide photographs of intended plant material along with signed clarification that plant material meets these requirements and that no variations or substitutions have been made.
- The Landscape Contractor doing the installation of this work shall submit to Kudela & Weinheimer information regarding sourcing of plant material. All plant material must be container-grown and approved at the source of growth by Kudela & Weinheimer. Tree material meeting the specifications will be tagged with a serialized locking tag at the nursery by Kudela & Weinheimer. Plants arriving at the job site without these tags will be categorically rejected at contractor's expense.
- If the planting plan does not agree with the plant list the quantities indicated graphically on the planting plan shall govern.
- Contractor is responsible for the grading of parking lot islands and setbacks. Grade changes shall range from 8" to 15" above the curb depending on the size of the island. Select topsoil shall be used for these berms. See Parking Island Tree Detail.
- All unsurfaced areas are to receive four inches of topsoil, seed, mulch or sod, and watered until a healthy stand of grass is established.

LEGEND

	EXISTING TREE
	NURSERY GROWN CONTAINERIZED TREES
	MEDJOO' PALM
	LOBLOLLY PINE
	MULTI-TRUNK TREES
	SHRUBS/GROUNDCOVER
	SOLID SOD - BERMUDA

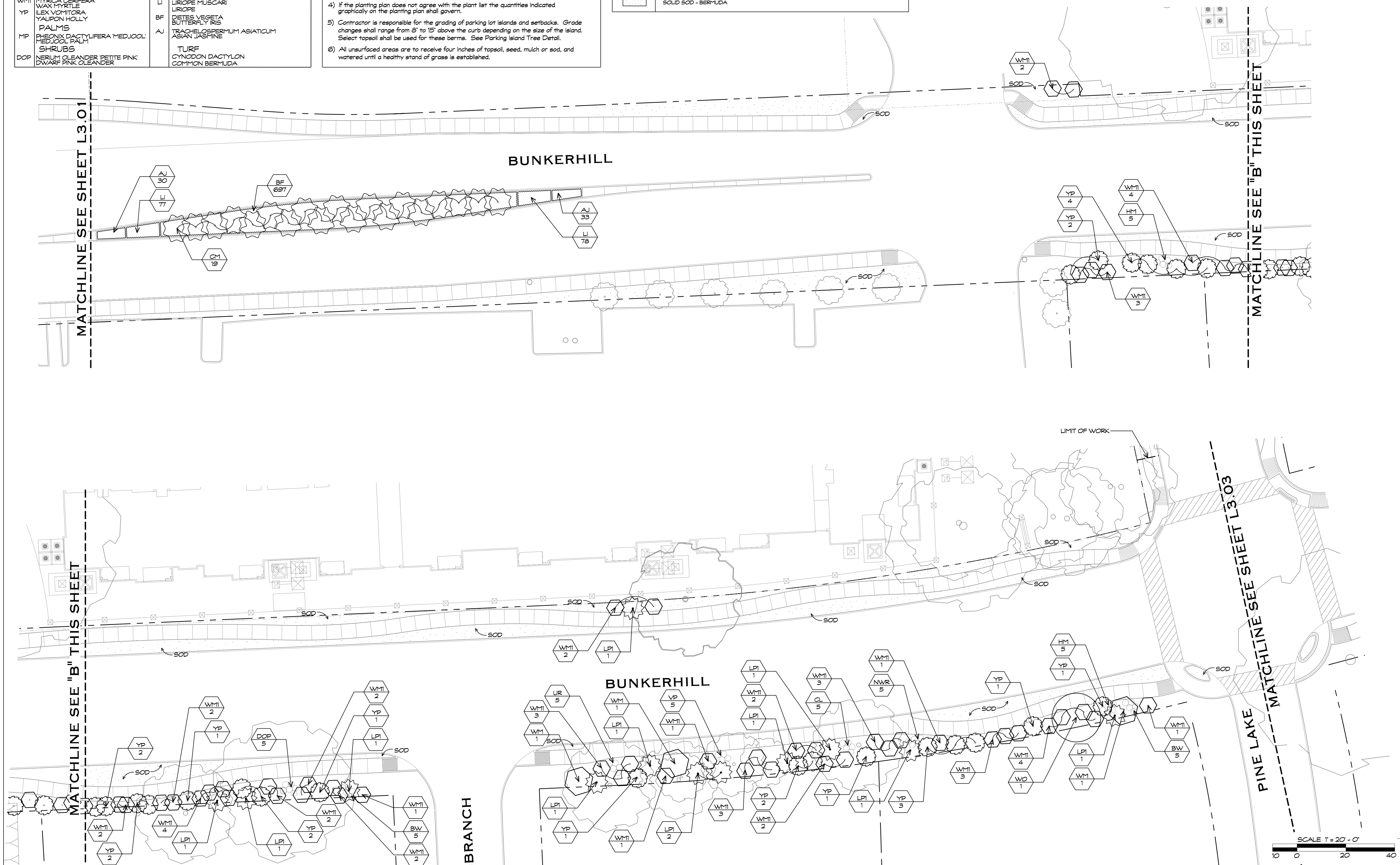

BUNKERHILL ROAD

MEMORIAL CITY DISTRICT

DATE/ISSUE
02 NOVEMBER 2007 ISSUED FOR REVIEW
16 NOVEMBER 2007 ISSUED FOR REVIEW
12 DECEMBER 2007 ISSUED FOR CONSTRUCTION

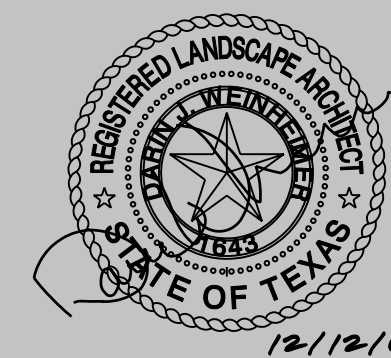

LANDSCAPE ARCHITECTURE
SITE PLANNING
URBAN DESIGN

7155 OLD KATY ROAD
SUITE 270
HOUSTON, TEXAS 77024
713-869-8987
713-869-0908 FAX
WWW.KWTEXAS.COM

PROJECT NUMBER
MCD-705

SCALE 1" = 20' - 0"

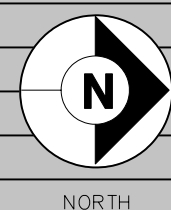

SHEET TITLE
PLANTING PLAN

SHEET NUMBER
L3.02

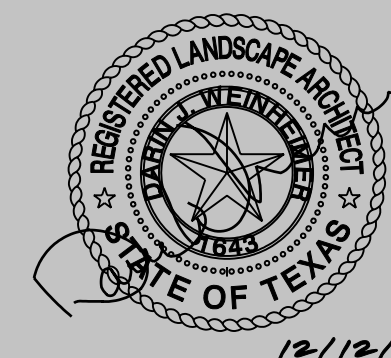

LANDSCAPE ARCHITECTURE
SITE PLANNING
URBAN DESIGN

7155 OLD KATY ROAD
SUITE 270
HOUSTON, TEXAS 77024
713-869-8987
713-869-0908 FAX
WWW.KWTEXAS.COM

PROJECT NUMBER
MCD-705

SCALE 1" = 20' - 0"

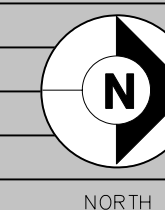

SHEET TITLE
IRRIGATION PLAN

SHEET NUMBER
L4.01

SYMBOL	MANUFACTURER/ MODEL NUMBER
	HUNTER ACC DECODER CONTROLLER 2-Wire System
	RAIN SENSOR - HUNTER MINI-CLK or RAIN-CLK CONTRACTOR TO INSTALL ALL WIRING IN HARD CONDUIT TO ROOF.
	POINT OF CONNECTION
	2" WATER METER - by IRRIGATION CONTRACTOR
	BACKFLOW PREVENTOR - FIBCO MODEL NUMBER 765 TWO INCH PVB AS ALLOWABLE BY PREVAILING CODE TO BE PROVIDED AND INSTALLED BY IRRIGATION CONTRACTOR
	GATEVALVE-LINE SIZE
	REMOTE CONTROL VALVE - RAINBIRD-PEB or HUNTER-ICV
	LAWN SPRAY HEADS - RAINBIRD 1804s or HUNTER PROS-04
	SHRUB SPRAY HEADS - RAINBIRD 1812s or HUNTER PROS-12 1" GROUND COVER AND 1804s or PROS-04 1" TALL SHRUBS. 15 FT. RADIUS SPRAY HEADS TO BE PLACED 12 FT. ON CENTER
	4' X 15' STRIP HEADS - RAINBIRD 15 CST and 15 EST
	ROTOR HEADS - HUNTER PSP-ADJ-04-LA USE ROTARY NOZZLES IF SPRAY HEADS ARE INDICATED ON ROTOR ZONES
	MAINLINE - SEE SPECIFICATIONS
	LATERAL LINE - SEE SPECIFICATIONS
	SCHEDULE 40 PVC SLEEVES, 4" & 6"

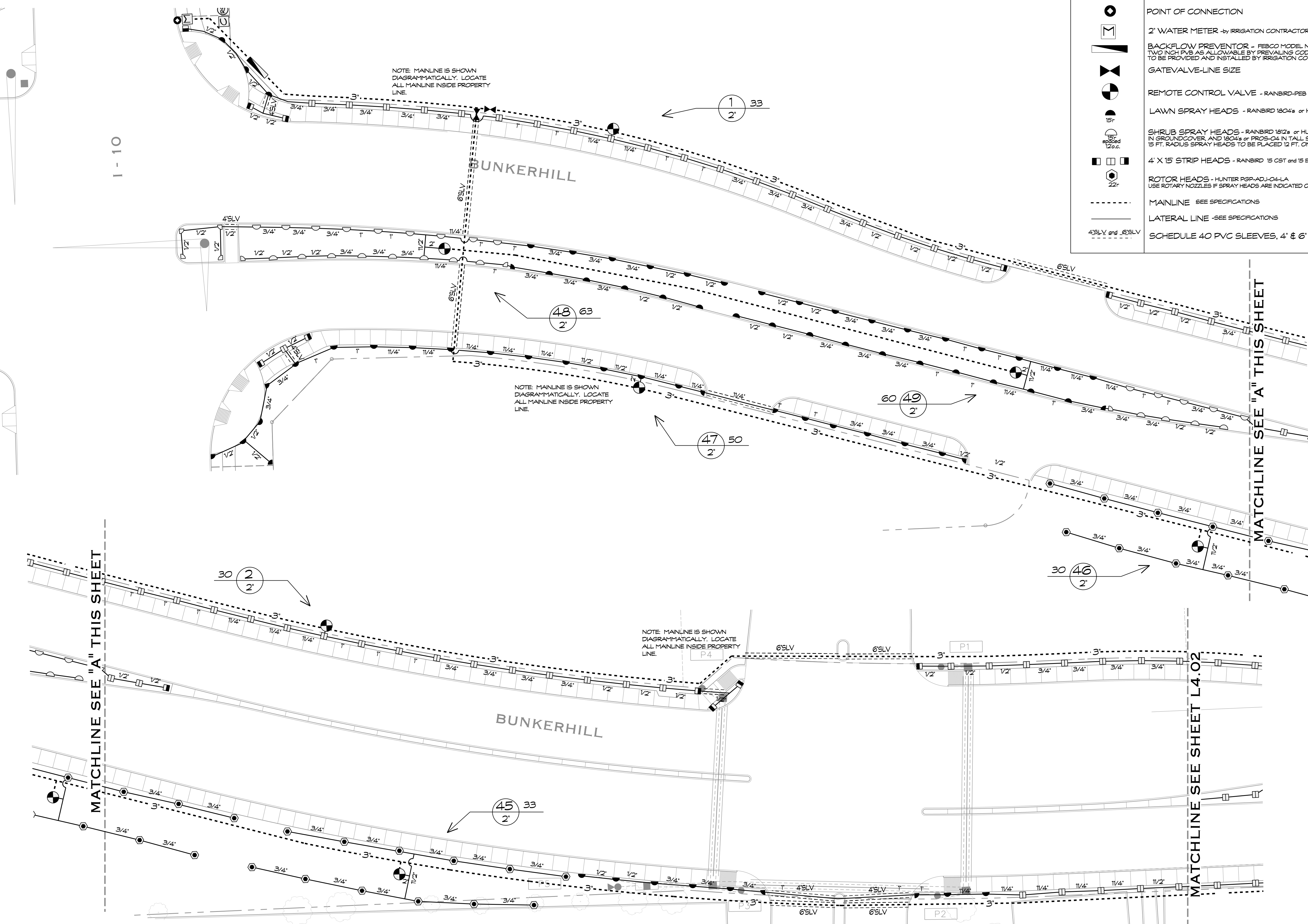

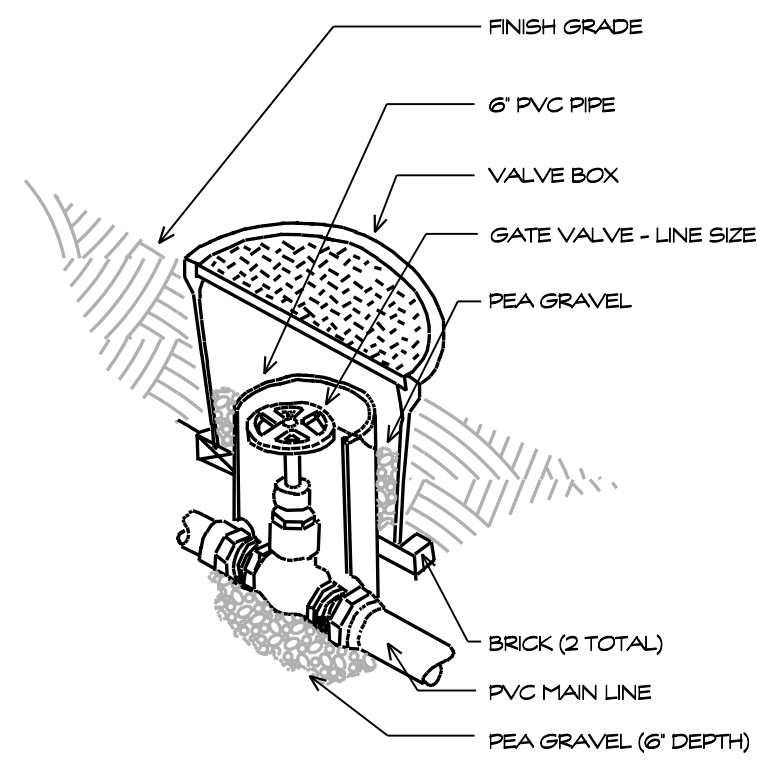

4 GATE VALVE DETAIL
NO SCALE

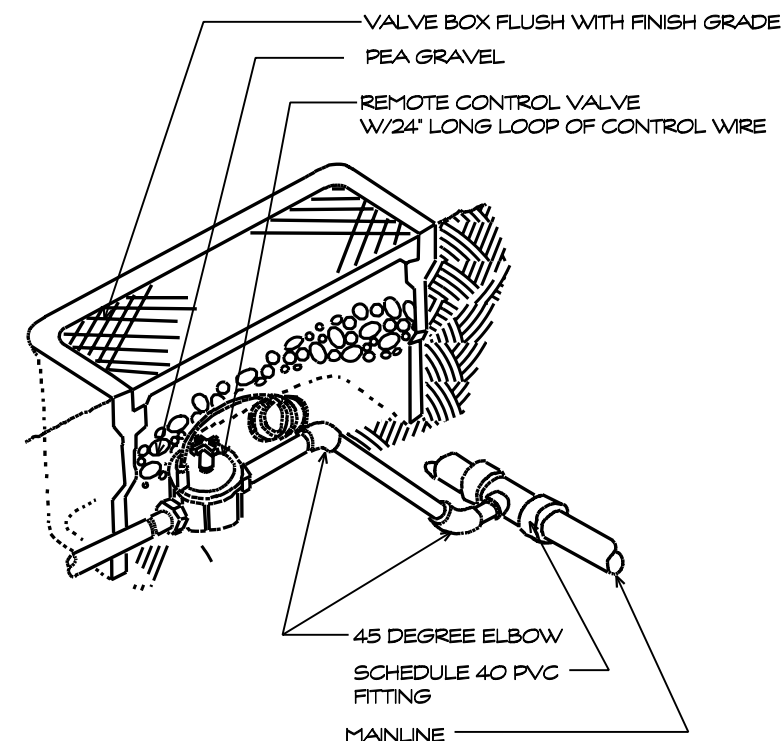

3 REMOTE CONTROL VALVE DETAIL
NO SCALE

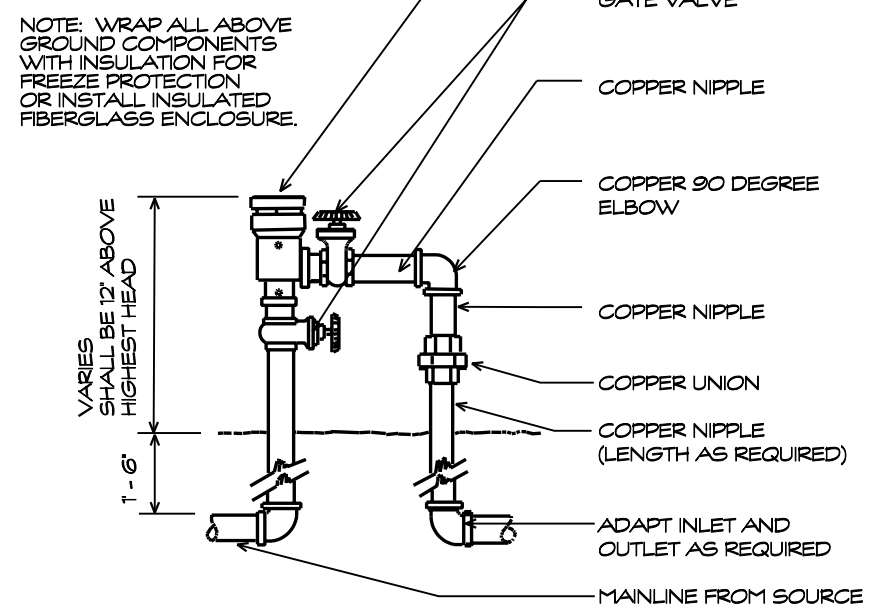

2 PRESSURE BACKFLOW PREVENTOR
NO SCALE

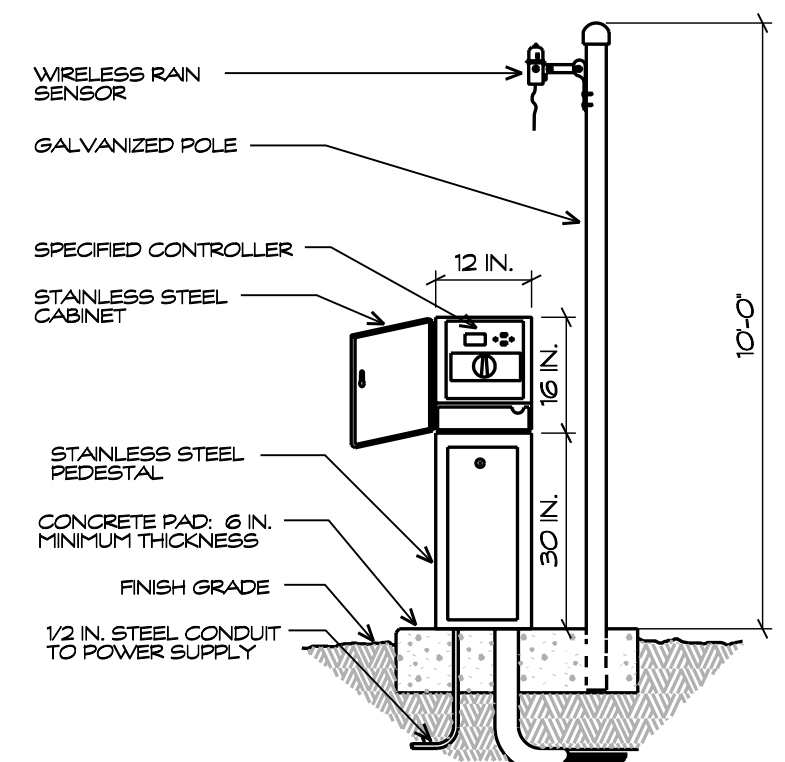

1 PEDESTAL W/ POLE MOUNTED SENSOR
NO SCALE

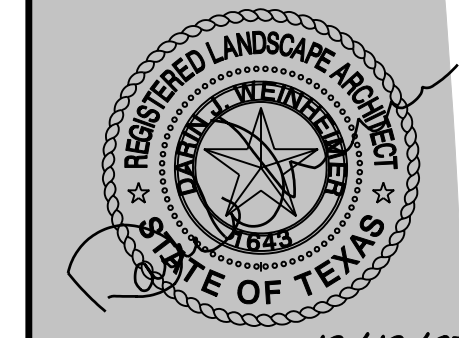
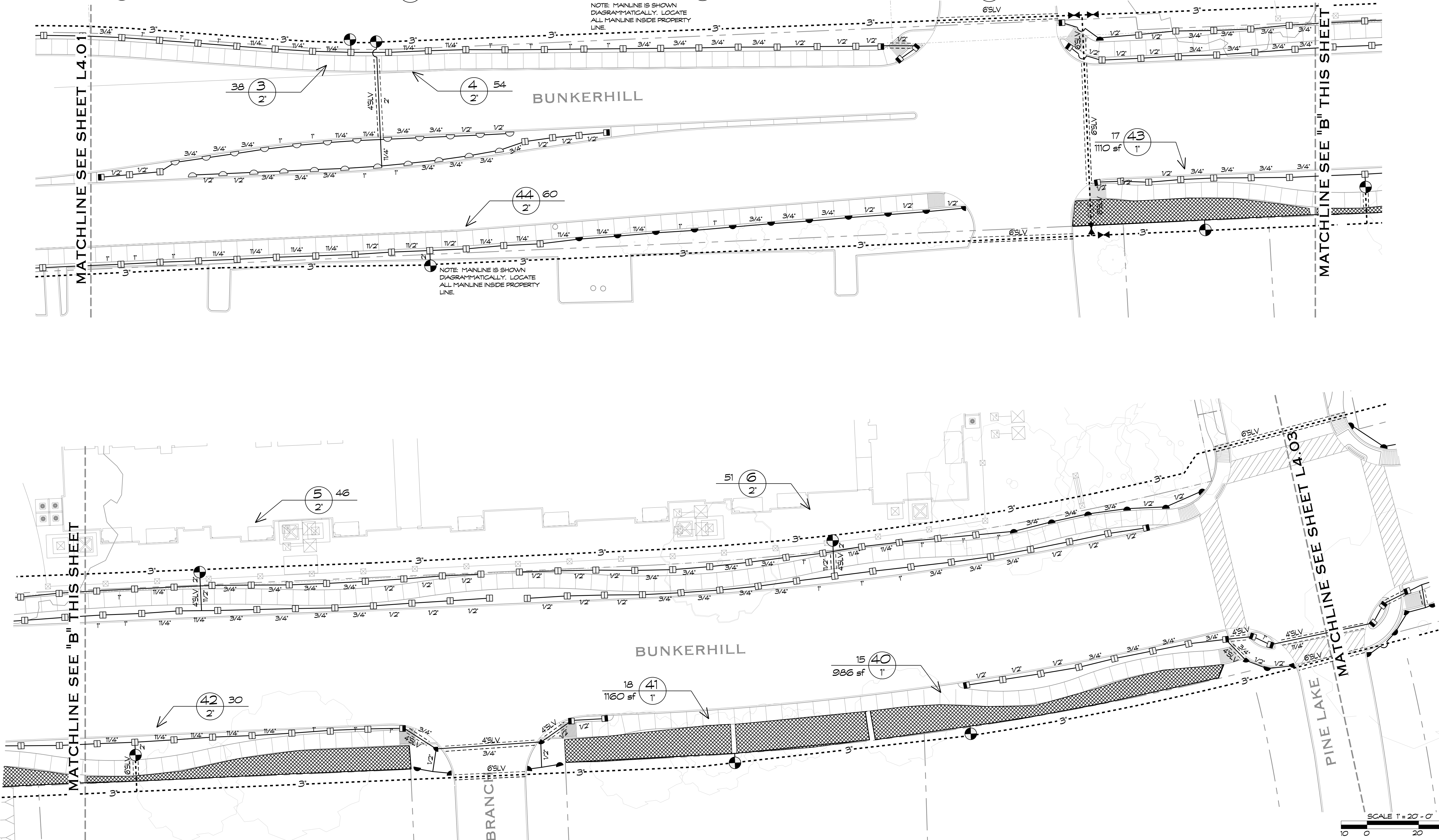

LANDSCAPE ARCHITECTURE
SITE PLANNING
URBAN DESIGN

7155 OLD KATY ROAD
SUITE 270
HOUSTON, TEXAS 77024
713-869-8987
713-869-0908 FAX
WWW.KWTEXAS.COM

PROJECT NUMBER
MCD-705

SCALE 1" = 20' - 0"

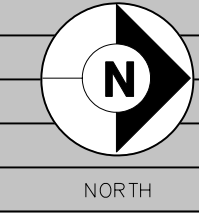

SHEET TITLE
IRRIGATION PLAN

SHEET NUMBER
L4.02